

12.6.2023

Rectum sample for chlamydia and gonorrhoea test using Aptima Multitest Swab Specimen Collection Kit

- The collection kit contains a swab and a sample transportation tube.
- Handle the sample transportation tube with care as the liquid in it irritates the skin. In case of skin contact, wash the skin immediately with water and soap. In case of eye contact, flush the eyes with plenty of water and contact the health care centre.
- Do NOT wash your genitals before sample collection.
- Do not moisten the swab stick with the transportation liquid or other liquid before sampling.

Sampling

- Wash your hands before sampling. Open the sample collection kit.
- Remove the swab from its protective package. Hold the swab with thumb-index finger grip around the black mark. Do not touch the cotton head of the swab and keep holding the swab in your hand.
- Insert the swab carefully into your rectum to a depth of about 3-5 cm. Roll the stick against mu-cous membranes for 5-10 seconds (do not take stool as a sample). Pull the swab out of your rectum. Keep the swab in your hand and be careful not to touch anything else with it.
- Open the cap of the sample transportation tube with your other hand. Do not break the folio part of the cap. Do not spill the transportation liquid.
- Insert the swab into the sample transportation tube. Make sure the swabs's black line is on the same level with the top of the tube.
- Cut the swab's lower part by pressing it against the edge of the sample tube. The lower part of the swab stick drops into the transportation liquid. The end of the stick remaining in your hand can be disposed with waste.
- Make sure that the swab remains in the transportation tube. **If the stick is not in the tube, the sample cannot be analysed.**
- Screw the cap of the sample transportation tube tightly shut to prevent the sample from leaking during transportation.
- The sample can be kept in room temperature.

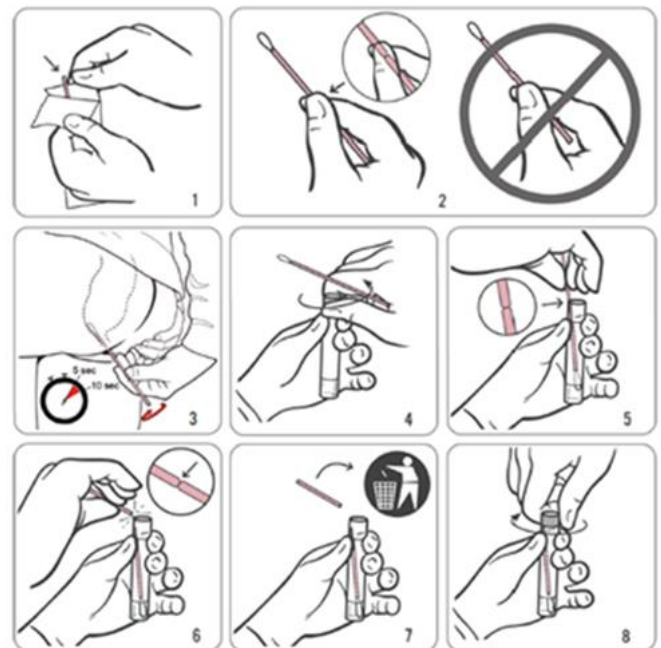

Let the person collecting the sample know if you were not able to follow these instructions or if you were given other kind of instructions.

You medical care physician or nurse will answer inquiries concerning testing and test results. The laboratory will answer questions related to sampling procedure.